

USAI RECESS 3 SERVICE INSTRUCTIONS RT Housing

CAUTION READ BEFORE INSTALLATION

- Retain these instructions for future reference. This product must be installed by a person familiar with the construction and operation of the product and the hazards involved, in accordance with applicable NEC code.
- Switch off main power before beginning installation.
- Install per national installation and accident prevention regulations.
- Clearance between sides of luminaire and parts of building to be 1/2 inch minimum; clearance to insulating materials to be 3 inch minimum, unless luminaire is IC rated.
- Fixtures must be installed in applications where the ambient temperature does not exceed 40° C during normal operation.
- **DO NOT** connect or disconnect LED board wire connector when the fixture is energized. This may result in permanent damage to the LED array.
- Warranty claims will not be accepted if incorrect driver or light engine is used.

DRIVER REPLACEMENT:

1. Remove the trim from the aperture: The trim is released by pulling straight down on outer flange

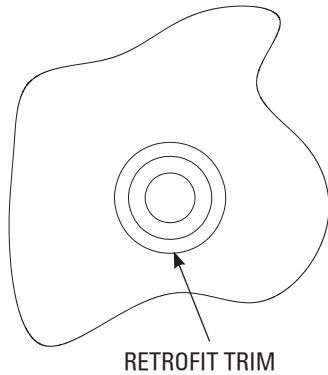

2. Identify (2) screws shown below and turn counter-clockwise to release mounting wings. You should see the trim collar begin to separate from ceiling.
3. Alternate turning each screw a little at a time, until you feel the weight of the fixture pushing it down.

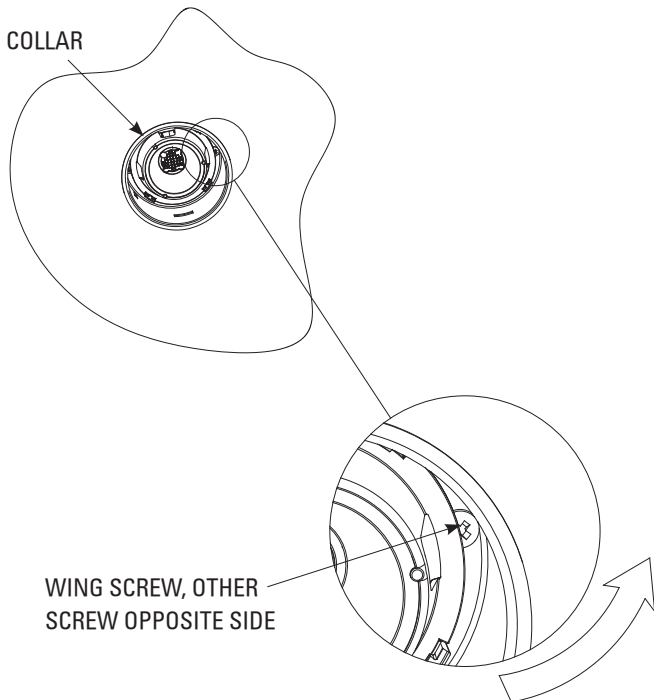

4. Pull the fixture down through the ceiling hole to access the splice compartment. Trim can be reinserted at this point if in the way.

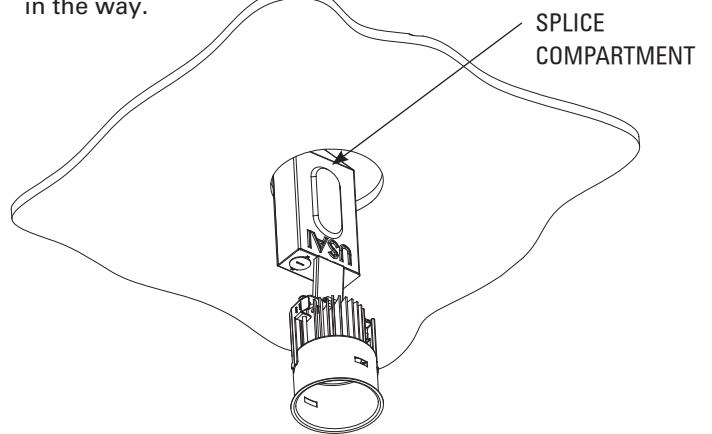

5. Open the splice compartment and replace the driver. Use flathead driver or 1/4" hex driver to remove back access screw, then lift cover off to access the driver. Use #2 Phillips driver to remove the driver and replace.
6. Install in reverse order, or see Installation Instructions for reinstallation.

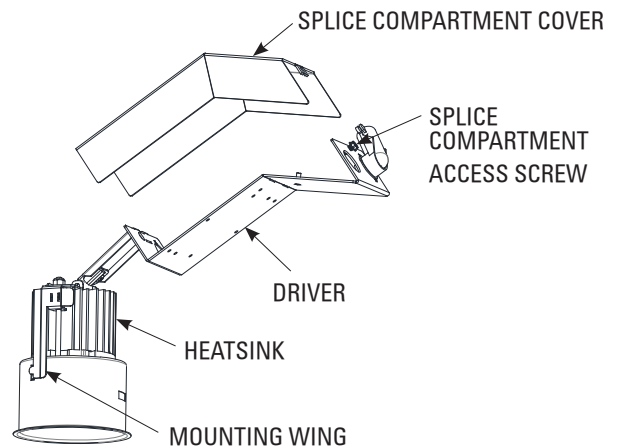

USAI RECESS 3 SERVICE INSTRUCTIONS RT Housing

CAUTION READ BEFORE INSTALLATION

- Retain these instructions for future reference. This product must be installed by a person familiar with the construction and operation of the product and the hazards involved, in accordance with applicable NEC code.
- Switch off main power before beginning installation.
- Install per national installation and accident prevention regulations.
- Clearance between sides of luminaire and parts of building to be 1/2 inch minimum; clearance to insulating materials to be 3 inch minimum, unless luminaire is IC rated.
- Fixtures must be installed in applications where the ambient temperature does not exceed 40° C during normal operation.
- **DO NOT** connect or disconnect LED board wire connector when the fixture is energized. This may result in permanent damage to the LED array.
- Warranty claims will not be accepted if incorrect driver or light engine is used.

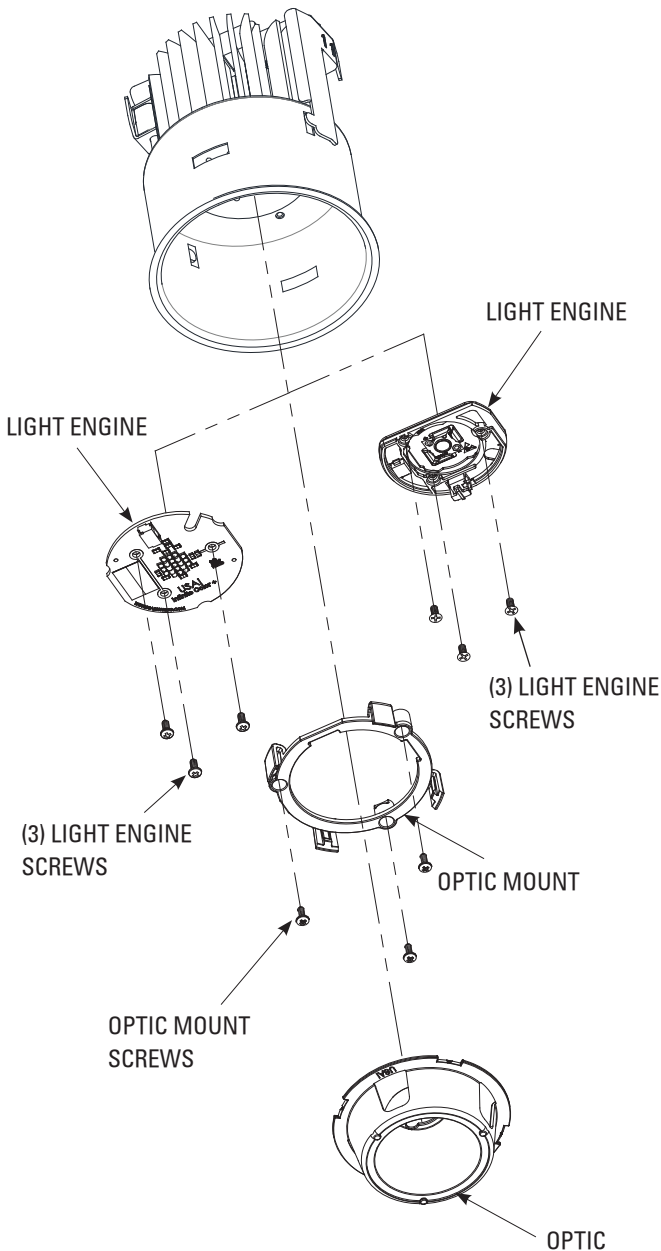

OPTICS REPLACEMENT:

1. Remove trim from aperture by polling straight down on outer flange
2. Remove optic by pulling straight down around flange and unsnapping from light engine.
3. Remove optic holder from optic.
4. Attach optic holder to new, desired optic.
5. Snap holder and optic back into light engine via (3) clearance holes.
6. Reinsert trim

LIGHT ENGINE REPLACEMENT:

1. Remove trim and optic(see optics replacement instructions)
2. Remove LED board connector:

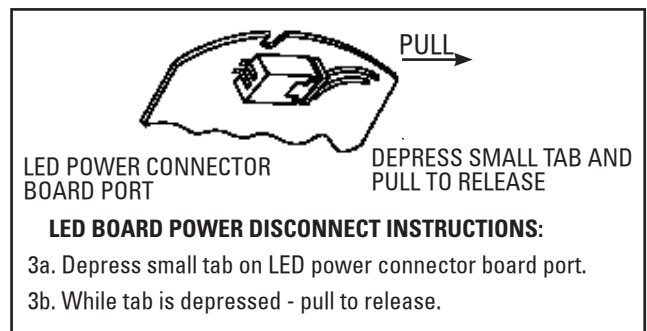

LED BOARD POWER DISCONNECT INSTRUCTIONS:

- 3a. Depress small tab on LED power connector board port.
 - 3b. While tab is depressed - pull to release.
3. Remove (3) 4-40 x 3/8" light engine screws holding light engine to heatsink and set aside.
 4. Remove light engine and replace in reverse order.