

# Recess Pinhole Warm Glow Dimming Adjustable



Photograph: Steve Munding Photography



**Universal and Field Convertible**  
Trim | Trimless

## Recess Pinhole Warm Glow Dimming Adjustable

An elegant solution for a variety of applications. Featuring clean, architectural grade finishes and beautiful light that shifts to warm as you dim, the Recess Pinhole installs beautifully into all ceiling types, including drywall, stone, and wood and makes every space look its best.

- **Ideal Applications:** Small-Scaled Spaces
- **Recommended for Ceiling Height:** 8' – 14'
- **Light Type:** White light that shifts to warm as you dim, indistinguishable from incandescent

### PINHOLE ADJUSTABLE PERFORMANCE DATA

Shape	Warm Glow Dimming	
	Round	Square
Delivered Lumens:	350	350
Lumens Per Watt:	21	21
Source Lumens:	625	
Wattage	16W	
CCT:	3000K dimmable to 2200K	
CRI:	90+	
Beamspread:	30°	
	Narrow Beam / Adjustable	



#### 4' SPACING BETWEEN LIGHT FIXTURES

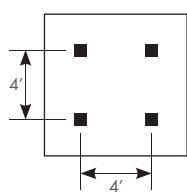

4' x 4' LAYOUT	CEILING HEIGHT			
Light levels at:	8'	10'	12'	14'
Light levels on Work Plane (2.5' AFF):	21	20	18	17
	(fc) foot candles			

#### 5' SPACING BETWEEN LIGHT FIXTURES

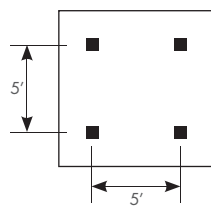

5' x 5' LAYOUT	CEILING HEIGHT			
Light levels at:	8'	10'	12'	14'
Light levels on Work Plane (2.5' AFF):	18	16	14	13
	(fc) foot candles			

#### 6' SPACING BETWEEN LIGHT FIXTURES

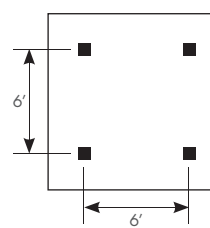

6' x 6' LAYOUT	CEILING HEIGHT			
Light levels at:	8'	10'	12'	14'
Light levels on Work Plane (2.5' AFF):	10	10	10	10
	(fc) foot candles			

#### 8' SPACING BETWEEN LIGHT FIXTURES

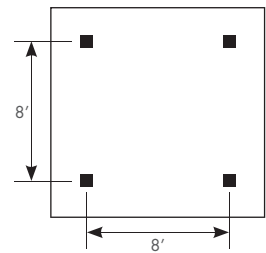

8' x 8' LAYOUT	CEILING HEIGHT			
Light levels at:	8'	10'	12'	14'
Light levels on Work Plane (2.5' AFF):	9	8	7	7
	(fc) foot candles			

Spacing Criteria = 0.48

Average light levels are provided in the tables above, for a range of lighting fixture layouts and ceiling heights. All illuminance values are reported in average footcandles (fc) and measured at the workplane, 30" above the floor.

**For approximate light level recommendations, please refer to the IES guidelines shown below:**

**Workshop / Tools / Crafts:** 40-100 fc  
**Board Games / Cards:** 20-40 fc  
**Dining:** 5-10 fc

**Kitchen:** 30-50 fc  
**Computer:** 15-30 fc  
**Media:** 2-20 fc

**Reading:** 20-50 fc  
**Dressing:** 10-30 fc  
**Corridors / Circulation:** 3-5 fc

# Recess Pinhole Warm Glow Dimming Adjustable



## Six Easy Steps to Specify

### 1 Select Housing Type

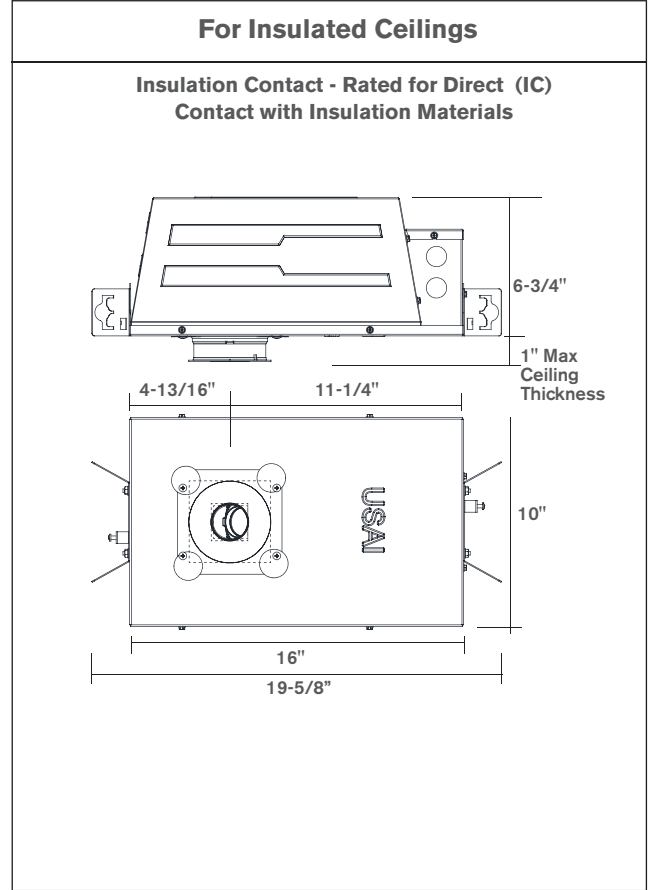
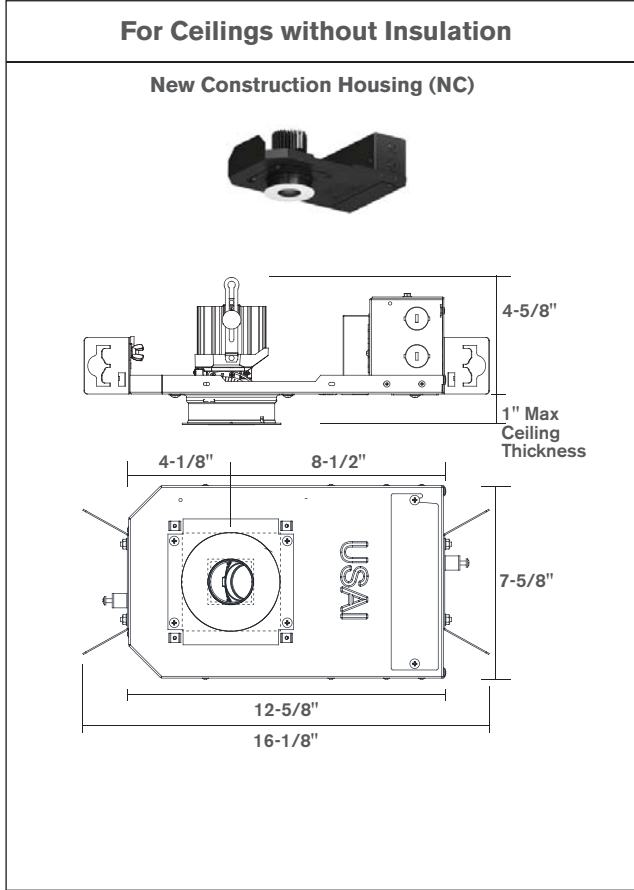

### 2 Select Dimming Control Type - Smooth Dimming to 1% Standard

0-10V Low Voltage Dimming (IV16A)



Compatible with 0-10V Controls

Phased Line Voltage Dimming (IP16A)

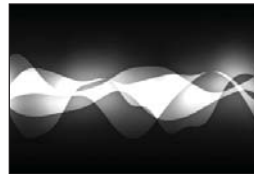

Compatible with Forward and Reverse Phase Dimmers

### 3 Select Shape

Round



Square



# Recess Pinhole Warm Glow Dimming Adjustable



## 4 Select Trim Style For Ceiling Type

**Trimmed (F)  
for All Ceiling  
Types**

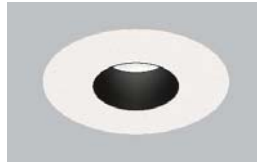

**Flush Mount (P)  
for Sheetrock Ceilings Only  
(Must be Spackled In)**



## 5 Select Glass Lens

**Solite (S)**  
provided standard

Light diffusion  
with the most  
efficiency



**Frosted (F)**

Medium diffusion  
for softer light  
output, approximately  
12% less light output



## 6 Select Trim Finish

**White (WH)**  
provided standard



**Black (BL)**



**Statuary  
Bronze (BZ)**



**Metalized  
Grey (GR)**



**Primer (PR)**

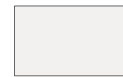

## How to Specify

Manufacturer	Light Fixture Type			LED + Control			Options				Revision
USAI	2DL	A1		WD1				E			00
USAI	Family	Function	Housing Type	LED Color	Wattage Driver	Shape	Style	Beam Spread	Lens	Finish	Version
USAI Lighting	2DL Pinhole Adjustable, 16W	A1 Adjustable Tilt and Aim Downlight	NC New Construction Housing  IC Insulation Contact Rated / Airtight	WD1 Warm Glow Dimming from 3000K, 90+ CRI at 100% output to 2200K at lowest output	IP16A Integral Phase Dimming Driver, to 1% 120V only, 16W  IV16A Integral 0-10V Dimming Driver, to 1% 120V-277V, 16W	R Round  S Square	F Trimmed  P Trimless / Flush Mount	E 30° Beam	S Solite Textured Glass (provided standard)  F Frosted Glass	WH White (provided standard)  BL Black  BZ Statuary Bronze  GR Metalized Grey  PR Primer Finish	00

# Recess Pinhole Warm Glow Dimming Adjustable

## RECESS PINHOLE SPECIFICATIONS

### FIELD REPLACEABLE LED LIGHT ENGINE

is serviceable through the aperture with a Philips screwdriver. All USAI Lighting LED light engines feature industry-leading color consistency. Warm Glow dimming light engines gradually shift color to a warm 2200K when dimmed, indistinguishable from incandescent.

### FIELD REPLACEABLE DIMMING DRIVER

is serviceable from below the ceiling through the aperture. Each solid state electronic constant current driver has a high power factor and sources 2mA. Drivers comply with IEEE62.41 surge protection. Some on-time delay may be experienced depending on control system used.

### FIXTURE WEIGHT

Standard housing with trim weighs 5.5 lbs, 16W IC housing weighs 10 lbs.

### HOUSING

Universal housing style allows the ability to swap trim styles between Downlight, Adjustable and Wall Wash. Fabricated of 18 ga. black powder coated steel with thru wire J-box, 2 in 2 out at min. 90°C, #12 AWG thru branch circuit wiring. IC housings are rated for direct contact with insulation up to R30 or less.

### MOUNTING

Butterfly brackets and adjustable nailer bars with integral nails provided. Nailer bars are extendible from 14" to 24" centers. Channel bars optionally available for dropped ceiling installation.

### CEILING CUT OUT

3-5/8" Ø

### LISTINGS

Dry/Damp/Wet. NRTL/CSA-US Tested to UL Standards. IBEW Union made. NC housing is UL2043 rated for use in Air Handling Plenum.



### NOTES

- Not for use in corrosive environment
- Use spackle collar accessory for flush-mount, spackle-in sheetrock applications
- Interior use only.

### PHOTOMETRICS

Consult factory or website for IES files. Tested in accordance with IESNA LM79.