

# Recess 3" Warm Glow Dimming Downlight



Photograph: Steve Munding Photography

## Recess 3 inch Warm Glow Dimming Downlight

An elegant solution for a variety of applications. Featuring clean, architectural grade finishes and beautiful light that shifts to warm as you dim, the Recess 3 installs beautifully into all ceiling types, including drywall, stone, and wood and makes every space look its best.

- **Ideal Applications:** Small to Medium-Scaled Spaces
- **Recommended for Ceiling Height:** 8' – 14'
- **Light Type:** White light that shifts to warm as you dim, indistinguishable from incandescent

### 3" DOWNLIGHT PERFORMANCE DATA

Shape	Warm Glow Dimming	
	Round	Square
Delivered Lumens:	675	675
Lumens Per Watt:	38	38
Source Lumens:	950	
Wattage	18W	
CCT:	3000K dimmable to 2200K	
CRI:	90+	
Beamspread:	50°	
	Wide Beam / Straight Down	

#### Round Trims



#### Square Trims



Universal and Field Convertible - Trim | Trimless | Millwork

#### 4' SPACING BETWEEN LIGHT FIXTURES

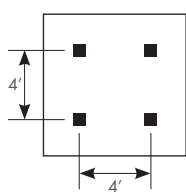

4' x 4' LAYOUT	CEILING HEIGHT			
Light levels at:	8'	10'	12'	14'
Light levels on Work Plane (2.5' AFF):	37	33	30	27
	(fc) foot candles			

#### 5' SPACING BETWEEN LIGHT FIXTURES

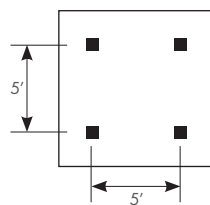

5' x 5' LAYOUT	CEILING HEIGHT			
Light levels at:	8'	10'	12'	14'
Light levels on Work Plane (2.5' AFF):	30	27	25	23
	(fc) foot candles			

#### 6' SPACING BETWEEN LIGHT FIXTURES

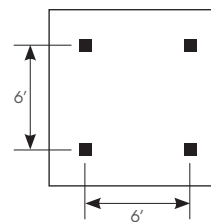

6' x 6' LAYOUT	CEILING HEIGHT			
Light levels at:	8'	10'	12'	14'
Light levels on Work Plane (2.5' AFF):	21	21	20	19
	(fc) foot candles			

#### 8' SPACING BETWEEN LIGHT FIXTURES

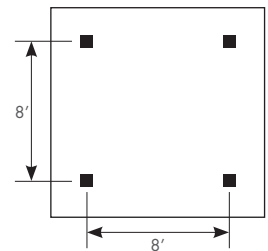

8' x 8' LAYOUT	CEILING HEIGHT			
Light levels at:	8'	10'	12'	14'
Light levels on Work Plane (2.5' AFF):	15	13	11	10
	(fc) foot candles			

Spacing Criteria = 0.76

Average light levels are provided in the tables above, for a range of lighting fixture layouts and ceiling heights. All illuminance values are reported in average footcandles (fc) and measured at the workplane, 30" above the floor.

For approximate light level recommendations, please refer to the IES guidelines shown below:

**Workshop / Tools / Crafts:** 40-100 fc  
**Board Games / Cards:** 20-40 fc  
**Dining:** 5-10 fc

**Kitchen:** 30-50 fc  
**Computer:** 15-30 fc  
**Media:** 2-20 fc

**Reading:** 20-50 fc  
**Dressing:** 10-30 fc  
**Corridors / Circulation:** 3-5 fc

# Recess 3" Warm Glow Dimming Downlight



## Six Easy Steps to Specify

### 1 Select Housing Type

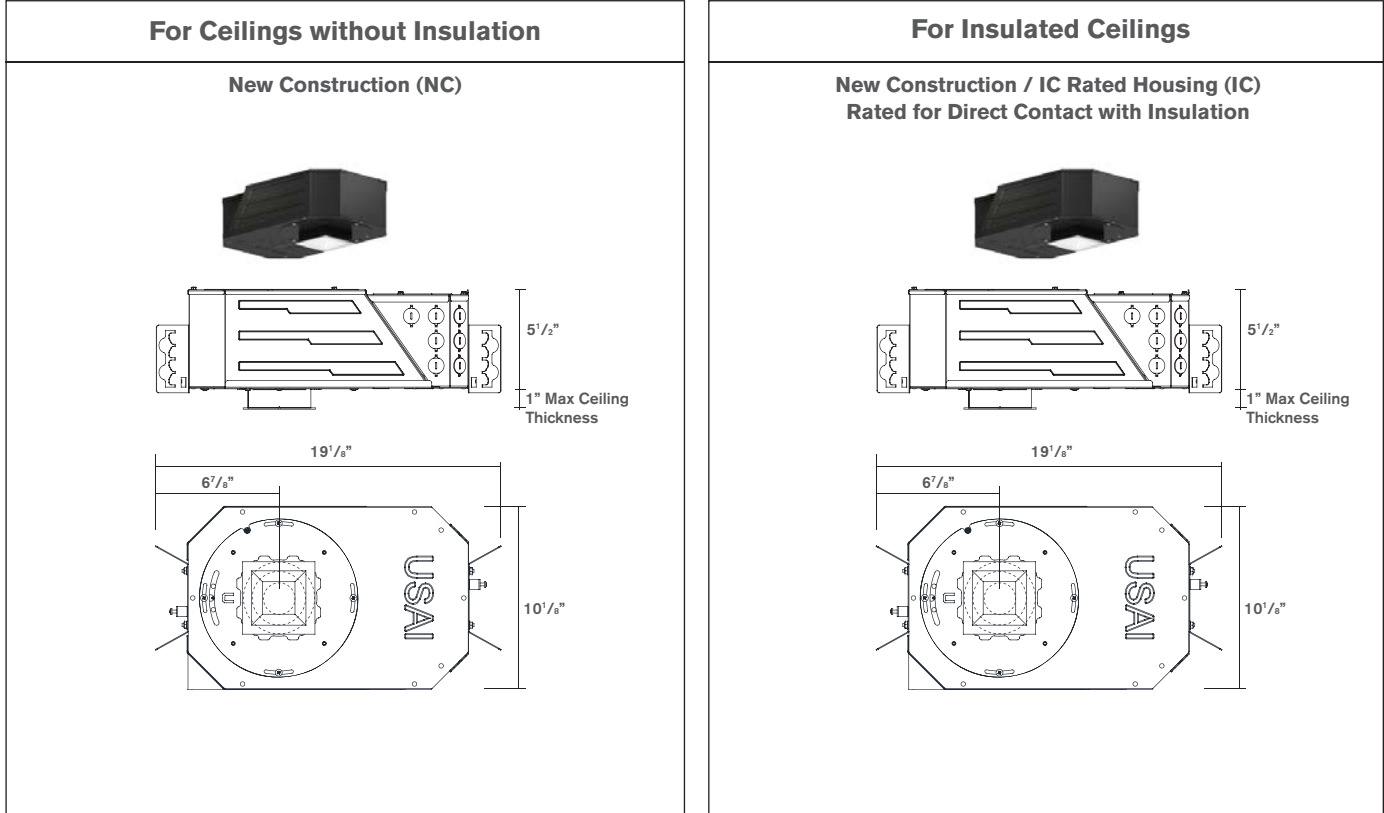

### 2 Select Dimming Control Type - Smooth Dimming to 1% Standard

0-10V Low Voltage Dimming (IV18A)



Compatible with 0-10V Controls

Phased Line Voltage Dimming (IP18A)

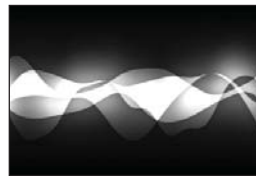

Compatible with Forward and Reverse Phase Dimmers

### 3 Select Shape

Square



Round



# Recess 3" Warm Glow Dimming Downlight



## 4 Select Trim Style For Ceiling Type



## 5 Select Glass Lens

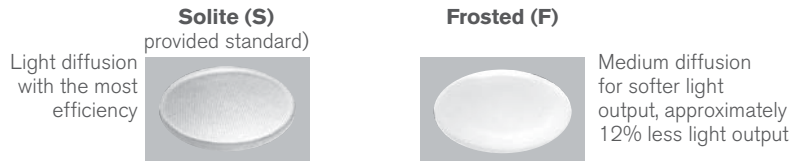

## 6 Select Trim Finish



## How to Specify

Manufacturer	Light Fixture Type			LED + Control			Options				Revision
USAI	3DL	D1		WD1				I			00
USAI	Family	Function	Housing Type	LED Color	Wattage Driver	Shape	Style	Beam Spread	Lens	Finish	Version
USAI Lighting	3DL 3" Downlight, 18W	D1 Fixed Downlight	NC New Construction Housing  IC New Construction / IC Rated Housing / Airtight	WD1 Warm Glow Dimming from 3000K, 90+ CRI at 100% output to 2200K at lowest output	IP18A Integral Phase Dimming Driver, to 1% 120V only, 18W  IV18A Integral 0-10V Dimming Driver, to 1% 120V-277V, 18W	R Round  S Square	F Trimmed  P Trimless  M Millwork	I 50° Beam	S Solite Textured Glass (provided standard)  F Frosted Glass	WH White (provided standard)  BL Black  BZ Statuary Bronze  GR Metalized Grey  PR Primer  AC Clear Matte Anodized  AB Black Anodized	00

# Recess 3" Warm Glow Dimming Downlight

## RECESS 3 SPECIFICATIONS

### FIELD REPLACEABLE LED LIGHT ENGINE

is serviceable through the aperture without tools. All USAI Lighting Warm Glow dimming light engines feature industry leading color consistency.

### FIELD REPLACEABLE DRIVER

Driver complies with IEEE62.41 surge protection. Multiple dimming driver options are available; some on-time delay may be experienced, depending on control system used.

### HOUSING:

Fabricated of 20 ga. galvanized steel with thru wire J-box, 4 in 4 out at min. 90°C, #12 AWG thru branch circuit wiring. IC-rated housings for use with 14W light engines only are rated for direct contact with insulation of R-42 or less.

### MOUNTING:

Butterfly brackets and adjustable nailer bars with integral nails provided. Nailer bars are extendible from 14" to 24" centers.

### CEILING CUT OUT:

Round: 3-1/2" Ø

Square: 3-1/2" x 3-1/2"

### LISTINGS:

Dry/Damp. Wet location option available with WH, BL, BZ, GR and PR trims only. NRTL/CSA-US tested to UL standards. IBEW union made.



### NOTES:

- Not for use in corrosive environment.
- Use of pressure washer voids warranty.

### PHOTOMETRICS:

Consult factory or website for IES files. Tested in accordance with IESNA LM79.