

Block 5 Classic White Downlight



Block 5 Classic White Downlight

Never lose ceiling height! Meet Block 5, our geometric light fixture specifically designed for use with surface-mounted conduit and junction boxes in exposed or industrial ceiling types where recessed lighting is not possible. Also available in solid sides configuration to create a modern look in finished ceilings – perfect for lofts, atriums, great rooms, and high-ceilinged spaces.

- **Ideal Applications:** Medium to Large-Scaled Spaces
- **Recommended for Ceiling Height:** 14' – 20'
- **Light Type:** Consistent warm or neutral white, soft ambient light

BLOCK 5 DOWNLIGHT PERFORMANCE DATA

Classic White

Shape	Round	Square
Delivered Lumens:	1450	1550
Lumens Per Watt:	60	65
Source Lumens:	1875	
Wattage	24W	
CCT:	2700K or 3000K	
CRI:	90+	
Beamspread:	50°	
	Wide Beam / Straight Down	



Conduit Cut Out



Round

Square

Solid Sides

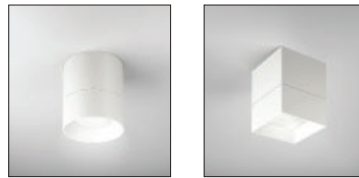

Round

Square

4' SPACING BETWEEN LIGHT FIXTURES

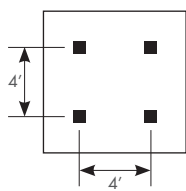

4' x 4' LAYOUT	CEILING HEIGHT
Light levels at:	8' 10' 12' 14' 16' 18' 20'
Light levels on Work Plane (2.5' AFF):	79 70 62 55 49 43 38 (fc) foot candles

5' SPACING BETWEEN LIGHT FIXTURES

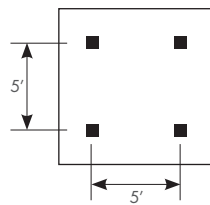

5' x 5' LAYOUT	CEILING HEIGHT
Light levels at:	8' 10' 12' 14' 16' 18' 20'
Light levels on Work Plane (2.5' AFF):	64 58 53 48 43 39 35 (fc) foot candles

6' SPACING BETWEEN LIGHT FIXTURES

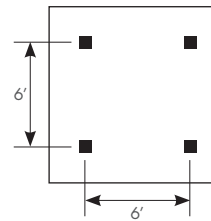

6' x 6' LAYOUT	CEILING HEIGHT
Light levels at:	8' 10' 12' 14' 16' 18' 20'
Light levels on Work Plane (2.5' AFF):	48 47 44 41 37 35 32 (fc) foot candles

8' SPACING BETWEEN LIGHT FIXTURES

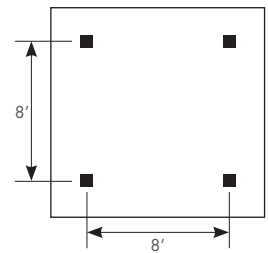

8' x 8' LAYOUT	CEILING HEIGHT
Light levels at:	8' 10' 12' 14' 16' 18' 20'
Light levels on Work Plane (2.5' AFF):	32 27 24 22 19 18 16 (fc) foot candles

Spacing Criteria = 0.73

Average light levels are provided in the tables above, for a range of lighting fixture layouts and ceiling heights. All illuminance values are reported in average footcandles (fc) and measured at the workplane, 30" above the floor.

For approximate light level recommendations, please refer to the IES guidelines shown below:

Workshop / Tools / Crafts: 40-100 fc
Board Games / Cards: 20-40 fc
Dining: 5-10 fc

Kitchen: 30-50 fc
Computer: 15-30 fc
Media: 2-20 fc

Reading: 20-50 fc
Dressing: 10-30 fc
Corridors / Circulation: 3-5 fc

Block 5

Classic White Downlight

Six Easy Steps to Specify

1 Select Installation Type

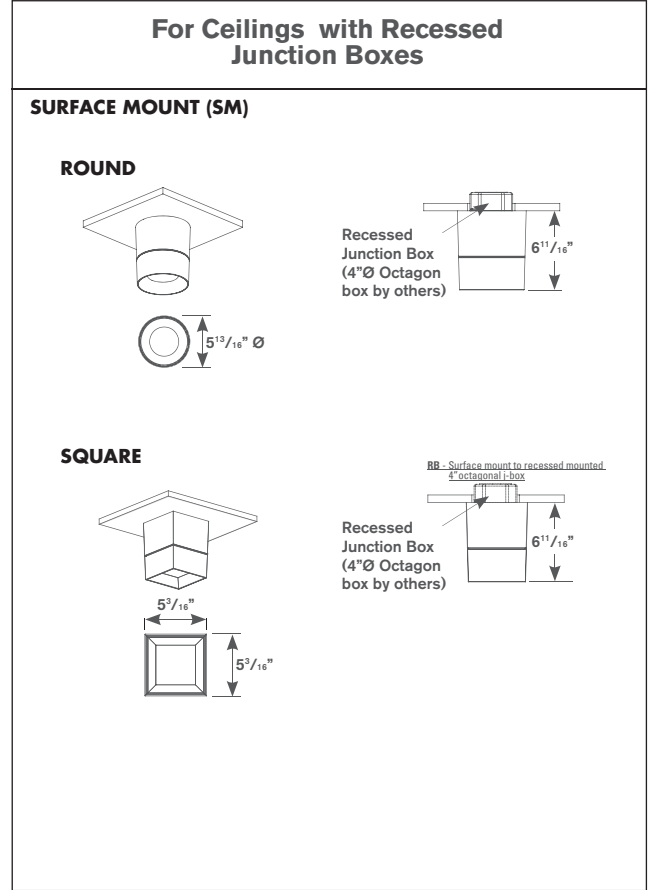
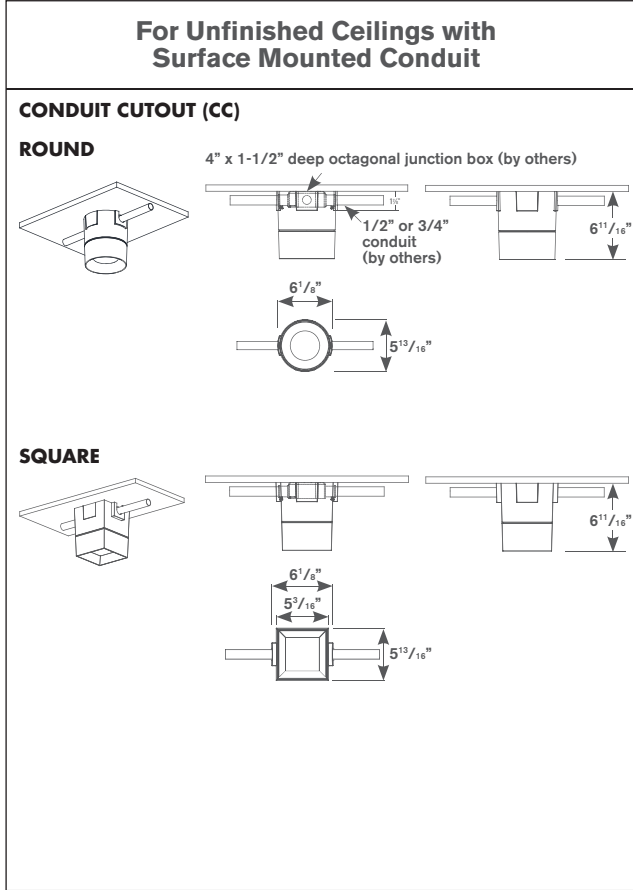

2 Select White Light

Warm White (C27)



2700 Kelvin
Similar to Incandescent

Neutral White (C30)



3000 Kelvin
Similar to Halogen

3 Select Dimming Control Type - Smooth Dimming to 1% Standard

0-10V Low Voltage Dimming (IV24A)



Compatible with 0-10V Controls

Phased Line Voltage Dimming (IP24A)

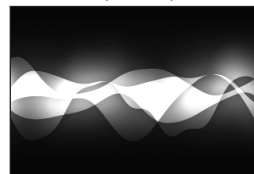

Compatible with Forward and Reverse Phase Dimmers

Block 5 Classic White Downlight



4 Select Fixture Shape

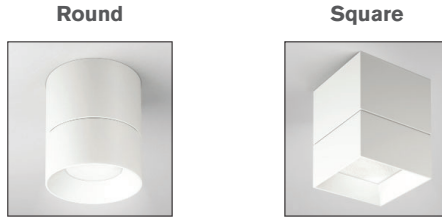

5 Select Glass Lens



6 Select Trim Finish

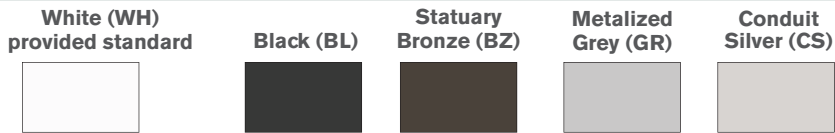

How to Specify

Manufacturer		Light Fixture Type			LED + Control			Options				Revision
USAI	5BK	D6					U	I			00	
USAI	Family	Function	Housing Type	LED Color	Wattage Driver	Shape	Style	Beam Spread	Lens	Finish	Version	
USAI Lighting	5BK Block 5 Downlight, 24W	D6 Fixed Downlight	SM Surface Mount to Recessed Junction Box	C27 Warm White 2700K High 90+ CRI C30 Neutral White 3000K High 90+ CRI	IP24A Integral Phase Dimming Driver, to 1% 120V only, 24W IV24A Integral 0-10V Dimming Driver, to 1% 120V-277V, 24W	R Round S Square	U One Piece Unit	I 50° Beam	S Solite Textured Glass (provided standard) F Frosted Glass	WH White (provided standard) BL Black BZ Statuary Bronze GR Metalized Grey CS Conduit Silver	00	
			CC Conduit Cutout Mount to Surface- Mounted Conduit and Junction Box	C27 Warm White 2700K High 90+ CRI C30 Neutral White 3000K High 90+ CRI	IP24A Integral Phase Dimming Driver, to 1% 120V only, 24W							

Block 5

Classic White Downlight

BLOCK 5 SPECIFICATIONS

FIELD REPLACEABLE LED LIGHT ENGINE

is serviceable without tools. All USAI Lighting Classic White light engines feature industry-leading color consistency

FIELD REPLACEABLE DRIVER

Driver complies with IEEE C62.41 surge protection. Some on-time delay may be experienced depending on control system used.

FIXTURE WEIGHT

Block 5 weighs 5 lbs

BODY

5-3/16" X 5-3/16" square die cast aluminum body available in a variety of powder coated paint finishes.

MOUNTING

CC: Conduit cutout mounting fixtures are designed to mount to surface-mounted 4" octagonal junction boxes with surface-mounted conduit connections. CC housings have 4 keyslots, one in each side, and ship with one conduit cutout key and three solid cover keys installed in the housing. 2 additional conduit cutout keys are shipped with the fixture, and the different key types are interchangeable in the field. Please see installation instructions for drawings and more details.

SM: Surface mounted fixtures are designed to mount to a ceiling with a recessed 4"Ø octagonal junction box. The sides are solid and have no cutouts, please see drawings and installation instructions for more details.

LISTINGS

Dry/Damp/Wet for RSM mounting. CC mounting style is dry/damp only. NRTL/CSA-US tested to UL standards. IBEW union made.



NOTES

- Ambient temperatures at fixture location should not exceed 40°C during normal operation.
- Consult factory for video capture applications.

PHOTOMETRICS

Consult factory or website for IES files. Tested in accordance with IESNA LM79.