

Block 5 Warm Glow Dimming Downlight



Block 5 Warm Glow Dimming Downlight

Never lose ceiling height! Meet Block 5, our geometric light fixture specifically designed to create a modern look in finished ceilings where recessed lighting is not possible – perfect for lofts, atriums, great rooms, and high-ceilinged spaces.

- **Ideal Applications:** Medium to Large-Scaled Spaces
- **Recommended for Ceiling Height:** 14' – 20'
- **Light Type:** White light that shifts to warm as you dim, indistinguishable from incandescent

BLOCK 5 DOWNLIGHT PERFORMANCE DATA

Warm Glow Dimming

Shape	Round	Square
Delivered Lumens:	875	925
Lumens Per Watt:	55	57
Source Lumens:	1025	
Wattage	16W	
CCT:	3000K dimmable to 2200K	
CRI:	90+	
Beamspread:	50°	
	Wide Beam / Straight Down	



Solid Sides



Round



Square

4' SPACING BETWEEN LIGHT FIXTURES

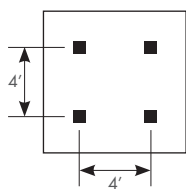

4' x 4' LAYOUT	CEILING HEIGHT
Light levels at:	8' 10' 12' 14' 16' 18' 20'
Light levels on Work Plane (2.5' AFF):	47 41 36 33 29 26 24 (fc) foot candles

5' SPACING BETWEEN LIGHT FIXTURES

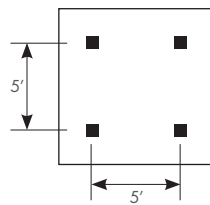

5' x 5' LAYOUT	CEILING HEIGHT
Light levels at:	8' 10' 12' 14' 16' 18' 20'
Light levels on Work Plane (2.5' AFF):	37 33 31 28 26 24 22 (fc) foot candles

6' SPACING BETWEEN LIGHT FIXTURES

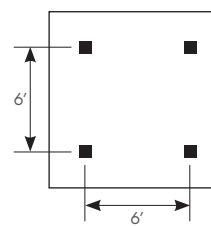

6' x 6' LAYOUT	CEILING HEIGHT
Light levels at:	8' 10' 12' 14' 16' 18' 20'
Light levels on Work Plane (2.5' AFF):	26 26 26 24 22 21 19 (fc) foot candles

8' SPACING BETWEEN LIGHT FIXTURES

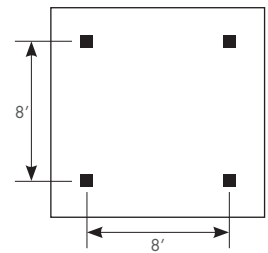

8' x 8' LAYOUT	CEILING HEIGHT
Light levels at:	8' 10' 12' 14' 16' 18' 20'
Light levels on Work Plane (2.5' AFF):	19 16 14 12 11 10 9 (fc) foot candles

Spacing Criteria = 0.95 for Round, 0.81 for Square

Average light levels are provided in the tables above, for a range of lighting fixture layouts and ceiling heights. All illuminance values are reported in average footcandles (fc) and measured at the workplane, 30" above the floor.

For approximate light level recommendations, please refer to the IES guidelines shown below:

Workshop / Tools / Crafts: 40-100 fc
Board Games / Cards: 20-40 fc
Dining: 5-10 fc

Kitchen: 30-50 fc
Computer: 15-30 fc
Media: 2-20 fc

Reading: 20-50 fc
Dressing: 10-30 fc
Corridors / Circulation: 3-5 fc

Block 5

Warm Glow Dimming Downlight

Four Easy Steps to Specify

1 Select Installation Type

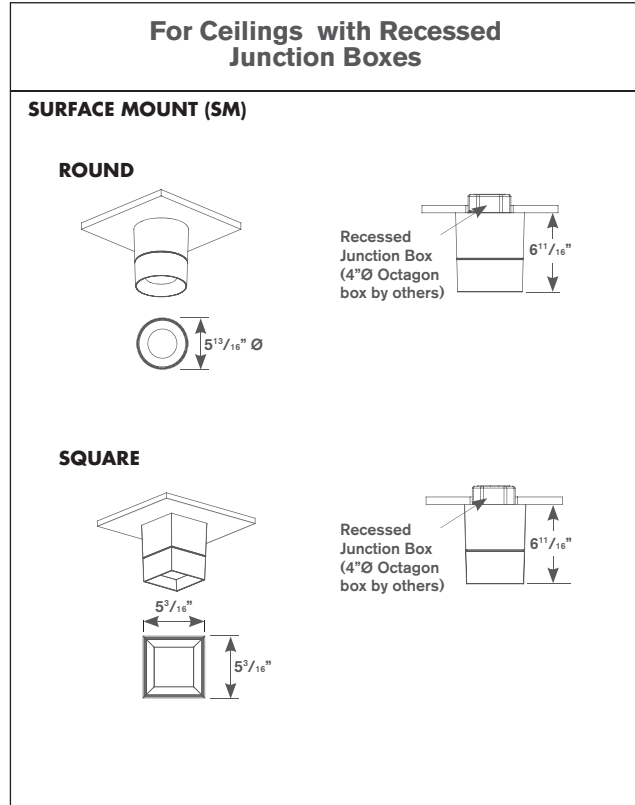

2 Select Fixture Shape

Round



Square



3 Select Glass Lens

Solite (S)

provided standard

Light diffusion with the most efficiency

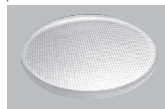

Frosted (F)

Medium diffusion for softer light output, approximately 12% less light output



Block 5

Warm Glow Dimming Downlight



4 Select Fixture Finish

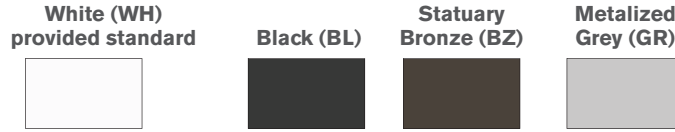

How to Specify

Manufacturer	Light Fixture Type			LED + Control		Options					Revision
USAI	5BK	D6		WD1	IV16A		U	I			00
USAI	Family	Function	Housing Type	LED Color	Wattage Driver	Shape	Style	Beam Spread	Lens	Finish	Version
USAI Lighting	5BK Block 5 Downlight, 16W	D6 Fixed Downlight	SM Surface Mount to Recessed Junction Box	WD1 Warm Glow Dimming from 3000K, 90+ CRI at 100% output to 2200K at lowest output	IV16A Integral 0-10V Dimming Driver, to 1% 120V-277V, 16W	R Round S Square	U One Piece Unit	I 50° Beam	S Solite Textured Glass (provided standard) F Frosted Glass	WH White (provided standard) BL Black BZ Statuary Bronze GR Metalized Grey	00

Block 5

Warm Glow Dimming Downlight

BLOCK 5 SPECIFICATIONS

FIELD REPLACEABLE LED LIGHT ENGINE

is serviceable without tools. All USAI Lighting Warm Glow Dimming light engines feature industry-leading color consistency

FIELD REPLACEABLE DRIVER

Driver complies with IEEE C62.41 surge protection. Some on-time delay may be experienced depending on control system used.

FIXTURE WEIGHT

Block 5 weighs 5 lbs

BODY

5-3/16" X 5-3/16" square die cast aluminum body available in a variety of powder coated paint finishes.

MOUNTING

SM: Surface mounted fixtures are designed to mount to a ceiling with a recessed 4"Ø octagonal junction box. The sides are solid and have no cutouts, please see drawings and installation instructions for more details.

LISTINGS

Dry/Damp/Wet for SM mounting. NRTL/CSA-US tested to UL standards. IBEW union made.



NOTES

- Ambient temperatures at fixture location should not exceed 40°C during normal operation.
- Consult factory for video capture applications.

PHOTOMETRICS

Consult factory or website for IES files. Tested in accordance with IESNA LM79.