

# Recess Multicell Classic White Adjustable



## Recess Multicell Classic White Adjustable

An elegant solution for a variety of applications. Featuring clean, architectural grade finishes and two high quality white light options, the Recess Multicell installs beautifully into all ceiling types, including drywall, stone, and wood and makes every space look its best.

- **Ideal Applications:** Small to Large-Scaled Spaces
- **Recommended for Ceiling Height:** 8' – 20'
- **Light Type:** Consistent warm or neutral white, soft ambient light

### MULTICELL ADJUSTABLE PERFORMANCE DATA

Classic White

Shape	4 Cell	8 Cell
Delivered Lumens:	775	1575
Lumens Per Watt:	60	59
Source Lumens:	1250	2425
Wattage	13W	27W
CCT:	2700K or 3000K	
CRI:	90+	
Beamspread:	30° Narrow Beam / Adjustable	

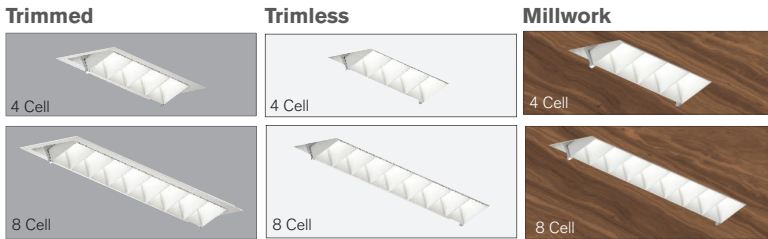

#### 4' SPACING BETWEEN LIGHT FIXTURES

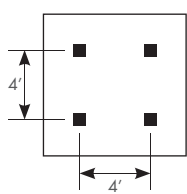

4' x 4' LAYOUT	CEILING HEIGHT						
Light levels at:	8'	10'	12'	14'	16'	18'	20'
4 Cell	47	42	39	36	33	31	29
8 Cell	94	85	78	72	67	62	58

#### 5' SPACING BETWEEN LIGHT FIXTURES

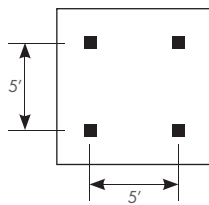

5' x 5' LAYOUT	CEILING HEIGHT						
Light levels at:	8'	10'	12'	14'	16'	18'	20'
4 Cell	38	34	31	29	28	26	25
8 Cell	77	68	63	59	56	53	50

#### 6' SPACING BETWEEN LIGHT FIXTURES

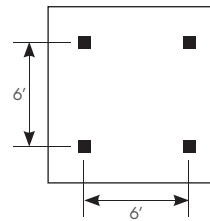

6' x 6' LAYOUT	CEILING HEIGHT						
Light levels at:	8'	10'	12'	14'	16'	18'	20'
4 Cell	24	23	23	23	22	22	21
8 Cell	47	47	46	46	45	43	42

#### 8' SPACING BETWEEN LIGHT FIXTURES

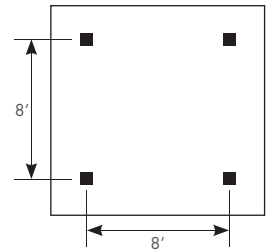

8' x 8' LAYOUT	CEILING HEIGHT						
Light levels at:	8'	10'	12'	14'	16'	18'	20'
4 Cell	20	18	16	14	13	12	11
8 Cell	41	36	31	28	25	24	22

All light levels are average illuminance on work plane (2.5' AFF) in foot candles.

Spacing Criteria = 0.5

Average light levels are provided in the tables above, for a range of lighting fixture layouts and ceiling heights. All illuminance values are reported in average footcandles (fc) and measured at the workplane, 30" above the floor.

**For approximate light level recommendations, please refer to the IES guidelines shown below:**

**Workshop / Tools / Crafts:** 40-100 fc  
**Board Games / Cards:** 20-40 fc  
**Dining:** 5-10 fc

**Kitchen:** 30-50 fc  
**Computer:** 15-30 fc  
**Media:** 2-20 fc

**Reading:** 20-50 fc  
**Dressing:** 10-30 fc  
**Corridors / Circulation:** 3-5 fc

# Recess Multicell Classic White Adjustable



## Five Easy Steps to Specify

### 1 Select Fixture Size

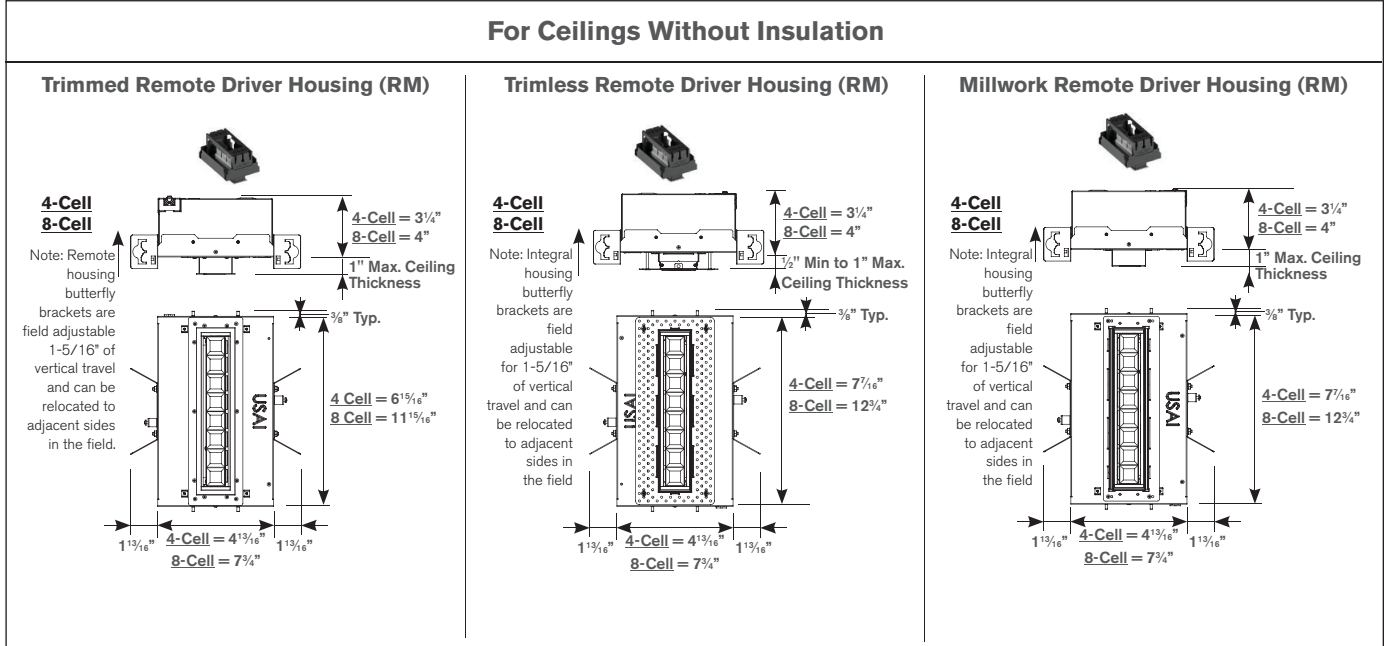

### 2 Select White Light



### 3 Select Dimming Control Type - Smooth Dimming to 1% Standard

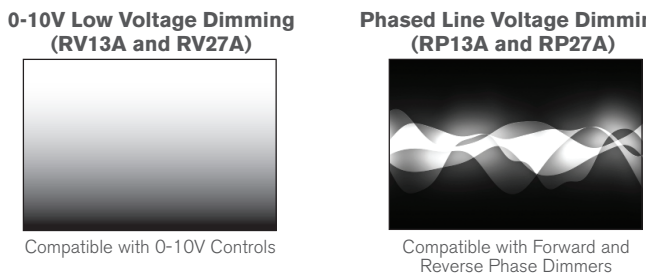

# Recess Multicell Classic White Adjustable

## 4 Select Trim Style For Ceiling Type

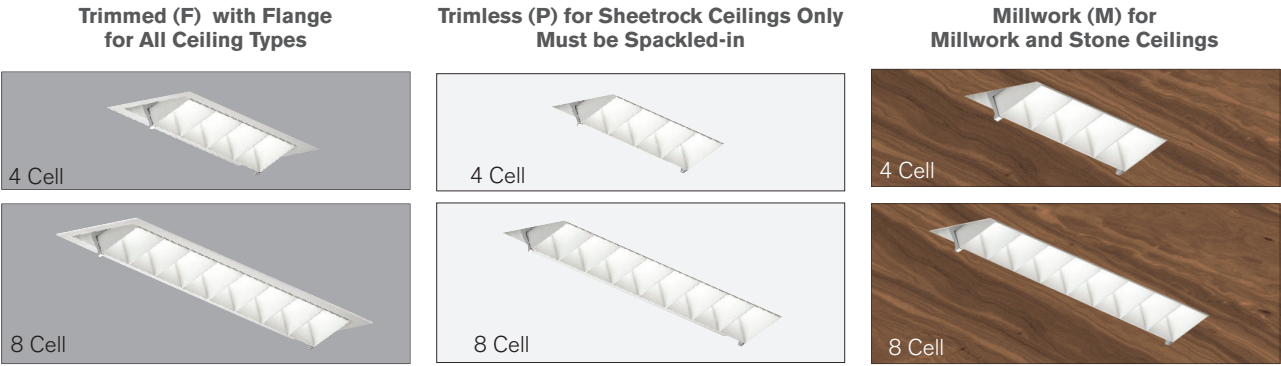

## 5 Select Trim Finish

### Trimmed, Millwork and Trimless Finish Options

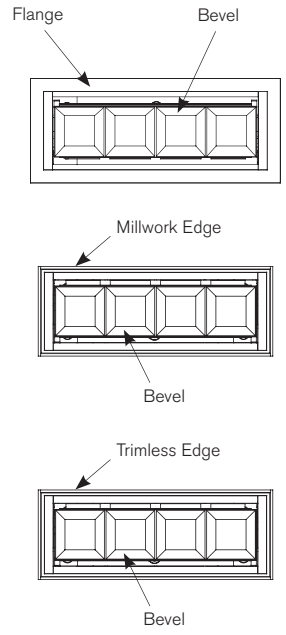
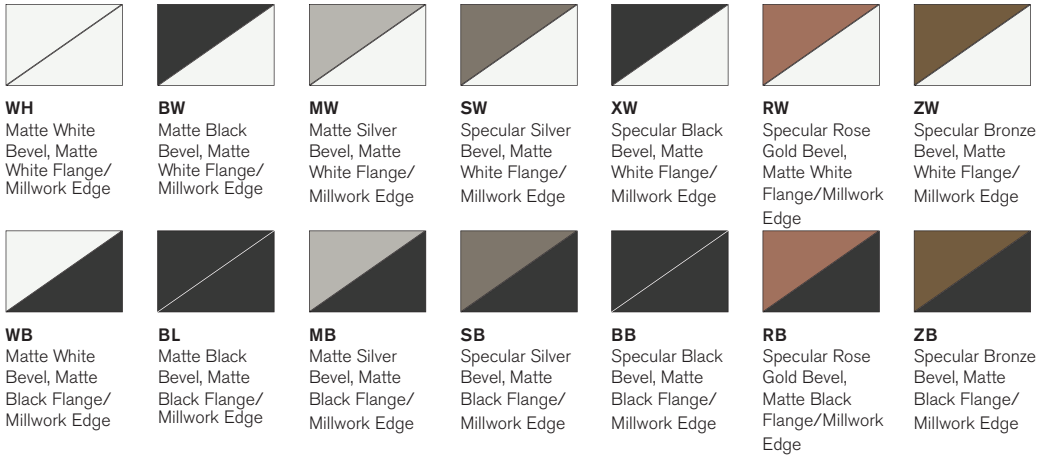

**See Next Page For  
How to Specify**

# Recess Multicell Classic White Adjustable



## How to Specify

Manufacturer	Light Fixture Type			LED + Control				Options			Rev
USAI	1MC	[ ]	RM	[ ]	[ ]	L	[ ]	E	M	[ ]	00
USAI	Family	Function	Housing Type	LED Color	Wattage Driver	Shape	Style	Beam Spread	Lens	Finish	Rev
USAI Lighting	1MC Recess Multicell	A4 4 Cell Adjustable, 13W	RM Remote Driver Housing	C27 Warm White 2700K High 90+ CRI  C30 Neutral White 3000K High 90+ CRI	RP13A Remote Phase Dimming Driver, to 1%, 120V only, 13W  RV13A Remote 0-10V Dimming Driver, to 1%, 120V-277V, 13W	L Linear	F Trimmed  M Millwork  P Trimless	E 30° Beam	M Multi Diffusion	<b>Trimmed and Millwork Finish Options</b> <b>WH</b> Matte White Bevel, Matte White Flange/Millwork <b>BW</b> Matte Black Bevel, Matte White Flange/Millwork <b>MW</b> Matte Silver Bevel, Matte White Flange/Millwork <b>SW</b> Specular Silver Bevel, Matte White Flange/Millwork <b>XW</b> Specular Black Bevel, Matte White Flange/Millwork <b>RW</b> Specular Rose Gold Bevel, Matte White Flange/Millwork <b>ZW</b> Specular Bronze Bevel, Matte White Flange/Millwork <b>WB</b> Matte White Bevel, Matte Black Flange/Millwork <b>BL</b> Matte Black Bevel, Matte Black Flange/Millwork <b>MB</b> Matte Silver Bevel, Matte Black Flange/Millwork <b>SB</b> Specular Silver Bevel, Matte Black Flange/Millwork <b>BB</b> Specular Black Bevel, Matte Black Flange/Millwork <b>RB</b> Specular Rose Gold Bevel, Matte Black Flange/Millwork <b>ZB</b> Specular Bronze Bevel, Black Flange/Millwork	00
		A8 8 Cell Adjustable, 27W		C27 Warm White 2700K High 90+ CRI  C30 Neutral White 3000K High 90+ CRI	RP27A Remote Phase Dimming Driver, to 1%, 120V only, 27W  RV27A Remote 0-10V Dimming Driver, to 1%, 120V-277V, 27W						

# Recess Multicell Classic White Adjustable



**FIELD REPLACEABLE LED LIGHT ENGINE**

is serviceable through the aperture with a Philips screwdriver. All USAI Lighting Classic White light engines feature industry-leading color consistency within a 2-Step MacAdam Ellipse.

**FIXTURE WEIGHT**

Weights do not include optional channel bar mounting hardware or remote drivers. RM Remote driver tray with trim weights:

1MCA4	1MCA8
2LBS	3LBS

**REMOTE DRIVER HOUSING**

New construction tray is fabricated of 20 ga. steel construction and is supplied with quick connects for use with remotely located driver. Driver is provided separately for remote location on site, enclosure to be provided by others.

**REMOTE LOCATION DRIVER**

Remote power supplies require enclosures by others that meet local codes and must be located in an accessible service panel within 100ft of the light fixture; see remote driver details for coordination of enclosure sizes. All dimming drivers comply with IEEE C62.41 surge protection.

**MOUNTING**

Butterfly brackets and adjustable nailer bars extendible from 14" to 24" centers with integral nails are provided for attachment to building structure. Butterfly brackets can be relocated in the field to adjacent sides of housing. C-channel bars are optionally available for acoustical ceiling applications.

**CEILING CUTOUT**

- 1MCA4F: 2-15/16" x 5-15/16"
- 1MCA8F: 2-15/16" x 10-15/16"
- 1MCA4P: 2-13/16" x 6-3/8"
- 1MCA8P: 2-13/16" x 11-3/8"
- 1MCA4M: 2-1/4" x 5-7/8"
- 1MCA8M: 2-1/4" x 10-7/8"

**LISTINGS**

Dry/Damp location. NRTL/CSA-US tested to UL standards. IBEW union made.

**NOTES**

- Not for use in corrosive environment
- Use of pressure washer voids warranty
- Ambient temperatures at fixture location should not exceed 40°C during normal operation.



**PHOTOMETRICS**

Consult factory or website for IES files. Tested in accordance with IESNA LM79.

**4 and 8-Cell Recess Multicell Remote Power Supply Requirements and Wiring Diagrams**  
Must be wired in homeruns per wiring diagram "A" below.

If you want to connect **1 fixture maximum** per power supply select from the following options:

Remote Power Supply Dimming Option	Dimming Driver Type	Wire Gauge Required*	Minimum Enclosure Size Required (by others)
RV13A	EldoLED 0-10V, 1%	18/16	6.25" W X 4" L X 2" H
RV27A	EldoLED 0-10V, 1%	18/16	6.25" W X 4" L X 2" H
RP13A	Hatch 2-wire phase, 1%	14/12	5.75" W X 2.625" L X 2" H
RP27A	Hatch 2-wire phase, 1%	14/12	5.75" W X 2.625" L X 2" H

Requirements and Wiring Diagrams for M1CA4, M1CA8

\* Wire gauge 14/12 = Maximum distance from light fixture to remote power supply is 100' using 12 gauge wire, 50' using 14 gauge wire.  
\* Wire gauge 18/16 = Maximum distance from light fixture to remote power supply is 100' using 16 gauge wire, 50' using 18 gauge wire.

