

Recess Multicell Classic White Downlight



Recess Multicell Classic White Downlight

An elegant solution for a variety of applications. Featuring clean, architectural grade finishes and two high quality white light options, the Recess Multicell installs beautifully into all ceiling types, including drywall, stone, and wood and makes every space look its best.

- **Ideal Applications:** Small to Large-Scaled Spaces
- **Recommended for Ceiling Height:** 8' – 20'
- **Light Type:** Consistent warm or neutral white, soft ambient light

MULTICELL DOWNLIGHT PERFORMANCE DATA

	Classic White		
Shape	2 Cell	4 Cell	8 Cell
Delivered Lumens:	425	825	1625
Lumens Per Watt:	57	64	61
Source Lumens:	625	1250	2425
Wattage	8W	13W	27W
CCT:	2700K or 3000K		
CRI:	90+		
Beamspread:	50° Wide Beam / Straight Down		

Trimmed

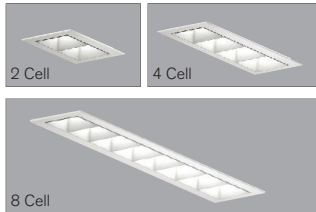

Trimless

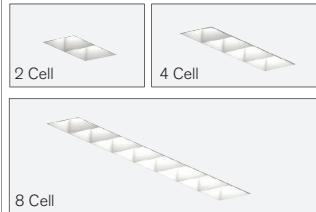

Millwork

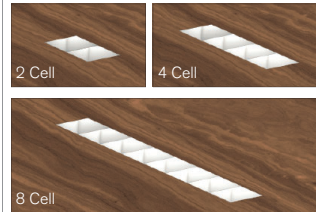

4' SPACING BETWEEN LIGHT FIXTURES

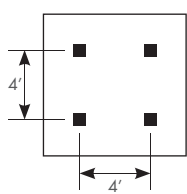

4' x 4' LAYOUT	CEILING HEIGHT						
Light levels at:	8'	10'	12'	14'	16'	18'	20'
2 Cell	22	20	18	16	15	13	12
4 Cell	45	39	35	32	29	26	24
8 Cell	87	76	68	62	57	52	47

5' SPACING BETWEEN LIGHT FIXTURES

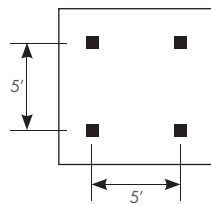

5' x 5' LAYOUT	CEILING HEIGHT						
Light levels at:	8'	10'	12'	14'	16'	18'	20'
2 Cell	18	16	15	14	13	12	11
4 Cell	35	32	29	27	25	23	21
8 Cell	69	62	57	53	49	46	42

6' SPACING BETWEEN LIGHT FIXTURES

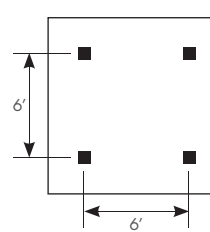

6' x 6' LAYOUT	CEILING HEIGHT						
Light levels at:	8'	10'	12'	14'	16'	18'	20'
2 Cell	12	12	12	12	11	10	9
4 Cell	25	24	24	23	22	20	19
8 Cell	49	48	47	45	42	40	37

8' SPACING BETWEEN LIGHT FIXTURES

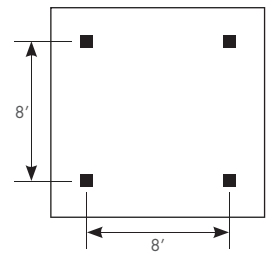

8' x 8' LAYOUT	CEILING HEIGHT						
Light levels at:	8'	10'	12'	14'	16'	18'	20'
2 Cell	9	8	7	6	6	5	5
4 Cell	19	15	13	12	11	10	10
8 Cell	36	30	26	23	22	20	19

All light levels are average illuminance on work plane (2.5' AFF) in foot candles.

Spacing Criteria = 0.78

Average light levels are provided in the tables above, for a range of lighting fixture layouts and ceiling heights. All illuminance values are reported in average footcandles (fc) and measured at the workplane, 30" above the floor.

For approximate light level recommendations, please refer to the IES guidelines shown below:

Workshop / Tools / Crafts: 40-100 fc
Board Games / Cards: 20-40 fc
Dining: 5-10 fc

Kitchen: 30-50 fc
Computer: 15-30 fc
Media: 2-20 fc

Reading: 20-50 fc
Dressing: 10-30 fc
Corridors / Circulation: 3-5 fc

Recess Multicell Classic White Downlight



Five Easy Steps to Specify

1

Select Fixture Size

For Ceilings Without Insulation

Trimmed Remote Driver Housing (RM)	Trimless Remote Driver Housing (RM)	Millwork Remote Driver Housing (RM)
<p>2-Cell</p> <p>Note: Integral housing butterfly brackets are field adjustable 1-5/16" of vertical travel and can be relocated to adjacent sides in the field</p> <p>4-Cell 8-Cell</p> <p>Note: Remote housing butterfly brackets are field adjustable 1-5/16" of vertical travel and can be relocated to adjacent sides in the field.</p>	<p>2-Cell, 4-Cell, 8-Cell</p> <p>Note: Integral housing butterfly brackets are field adjustable for 1-5/16" of vertical travel and can be relocated to adjacent sides in the field</p>	<p>2-Cell, 4-Cell, 8-Cell</p> <p>Note: Integral housing butterfly brackets are field adjustable for 1-5/16" of vertical travel and can be relocated to adjacent sides in the field</p>

2

Select White Light

Warm White (C27)



2700 Kelvin
Similar to Incandescent

Neutral White (C30)



3000 Kelvin
Similar to Halogen

3

Select Dimming Control Type - Smooth Dimming to 1% Standard

0-10V Low Voltage Dimming (RV08A, RV13A and RV27A)



Compatible with 0-10V Controls

Phased Line Voltage Dimming (RP13A and RP27A)

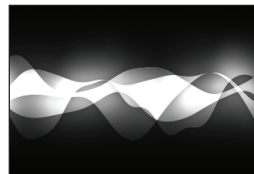

Compatible with Forward and Reverse Phase Dimmers

Recess Multicell Classic White Downlight

4 Select Trim Style For Ceiling Type

Trimmed (F) with Flange for All Ceiling Types	Trimless (P) for Sheetrock Ceilings Only Must be Spackled-in	Millwork (M) for Millwork and Stone Ceilings
2 Cell 4 Cell	2 Cell 4 Cell	2 Cell 4 Cell
8 Cell	8 Cell	8 Cell

5 Select Trim Finish

Trimmed and Millwork Finish Options

WH Matte White Bevel, Matte White Flange/ Millwork Edge	BW Matte Black Bevel, Matte White Flange/ Millwork Edge	MW Matte Silver Bevel, Matte White Flange/ Millwork Edge	SW Specular Silver Bevel, Matte White Flange/ Millwork Edge	XW Specular Black Bevel, Matte White Flange/ Millwork Edge	RW Specular Rose Gold Bevel, Matte White Flange/ Millwork Edge	ZW Specular Bronze Bevel, Matte White Flange/ Millwork Edge
WB Matte White Bevel, Matte Black Flange/ Millwork Edge	BL Matte Black Bevel, Matte Black Flange/ Millwork Edge	MB Matte Silver Bevel, Matte Black Flange/ Millwork Edge	SB Specular Silver Bevel, Matte Black Flange/ Millwork Edge	BB Specular Black Bevel, Matte Black Flange/ Millwork Edge	RB Specular Rose Gold Bevel, Matte Black Flange/ Millwork Edge	ZB Specular Bronze Bevel, Matte Black Flange/ Millwork Edge

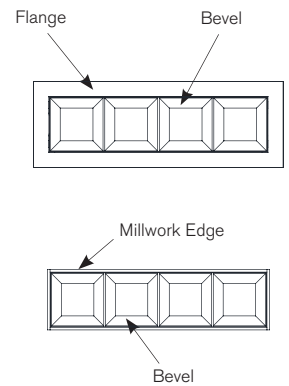

Trimless Finish Options

WH Matte White Bevel, Trimless/ Spackle-in	BL Matte Black Bevel, Trimless/ Spackle-in	MS Matte Silver Bevel, Trimless/ Spackle-in	SS Specular Silver Bevel, Trimless/ Spackle-in	SK Specular Black Bevel, Trimless/ Spackle-in	RG Specular Rose Gold Bevel, Trimless/ Spackle-in	SZ Specular Bronze Bevel, Trimless/ Spackle-in

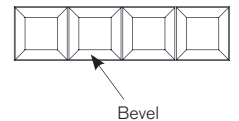

See Next Page For How to Specify

Recess Multicell Classic White Downlight



How to Specify

Manufacturer	Light Fixture Type			LED + Control				Options			Rev	
USAI	1MC	[]	RM	[]	[]	L	[]	I	M	[]	00	
USAI	Family	Function	Housing Type	LED Color	Wattage Driver	Shape	Style	Beam Spread	Lens	Finish	Rev	
USAI Lighting	1MC Recess Multicell	D2 2 Cell Downlight, 8W	RM Remote Driver Housing	C27 Warm White 2700K High 90+ CRI C30 Neutral White 3000K High 90+ CRI	RV08A Remote 0-10V Dimming Driver, to 1%, 120V-277V, 8W RP13A Remote Phase Dimming Driver, to 1%, 120V only, 13W RV13A Remote 0-10V Dimming Driver, to 1%, 120V-277V, 13W	L Linear	F Trimmed M Millwork	I 50° Beam	M Multi Diffusion	Trimmed and Millwork Finish Options WH Matte White Bevel, Matte White Flange/Millwork BW Matte Black Bevel, Matte White Flange/Millwork MW Matte Silver Bevel, Matte White Flange/Millwork SW Specular Silver Bevel, Matte White Flange/Millwork XW Specular Black Bevel, Matte White Flange/Millwork RW Specular Rose Gold Bevel, Matte White Flange/Millwork ZW Specular Bronze Bevel, Matte White Flange/Millwork WB Matte White Bevel, Matte Black Flange/Millwork BL Matte Black Bevel, Matte Black Flange/Millwork MB Matte Silver Bevel, Matte Black Flange/Millwork SB Specular Silver Bevel, Matte Black Flange/Millwork BB Specular Black Bevel, Matte Black Flange/Millwork RB Specular Rose Gold Bevel, Matte Black Flange/Millwork ZB Specular Bronze Bevel, Black Flange/Millwork	00	
		D4 4 Cell Downlight, 13W		C27 Warm White 2700K High 90+ CRI C30 Neutral White 3000K High 90+ CRI								RP27A Remote Phase Dimming Driver, to 1%, 120V only, 27W RV27A Remote 0-10V Dimming Driver, to 1%, 120V-277V, 27W
		D8 8 Cell Downlight, 27W		C27 Warm White 2700K High 90+ CRI C30 Neutral White 3000K High 90+ CRI								RP27A Remote Phase Dimming Driver, to 1%, 120V only, 27W RV27A Remote 0-10V Dimming Driver, to 1%, 120V-277V, 27W
							P Trimless	I 50° Beam	M Multi Diffusion	Trimless Finish Options WH Matte White Bevel, Trimless/Spackle-in BL Matte Black Bevel, Trimless/Spackle-in MS Matte Silver Bevel, Trimless/Spackle-in SS Specular Silver Bevel, Trimless/Spackle-In SK Specular Black Bevel, Trimless/Spackle-In RG Specular Rose Gold Bevel, Trimless/Spackle-In SZ Specular Bronze Bevel, Trimless/Spackle-In		

Recess Multicell Classic White Downlight



FIELD REPLACEABLE LED LIGHT ENGINE

is serviceable through the aperture with a Philips screwdriver. All USAI Lighting Classic White light engines feature industry-leading color consistency within a 2-Step MacAdam Ellipse.

FIXTURE WEIGHT

Weights do not include optional channel bar mounting hardware or remote drivers. RM Remote driver tray with trim weights:

1MCD2	1MCD4	1MCD8
1LB	2LBS	3LBS

REMOTE DRIVER HOUSING

New construction tray is fabricated of 20 ga. steel construction and is supplied with quick connects for use with remotely located driver. Driver is provided separately for remote location on site, enclosure to be provided by others.

REMOTE LOCATION DRIVER

Remote power supplies require enclosures by others that meet local codes and must be located in an accessible service panel within 100ft of the light fixture; see remote driver details for coordination of enclosure sizes. All dimming drivers comply with IEEE C62.41 surge protection.

MOUNTING

Butterfly brackets and adjustable nailer bars extendible from 14" to 24" centers with integral nails are provided for attachment to building structure. Butterfly brackets can be relocated in the field to adjacent sides of housing. C-channel bars are optionally available for acoustical ceiling applications.

CEILING CUTOUT

- 1MCD2F: 1-11/16" x 2-15/16"
- 1MCD4F: 1-11/16" x 5-7/16"
- 1MCD8F: 1-11/16" x 10-7/16"
- 1MCD2P: 2" x 3-1/8"
- 1MCD4P: 2" x 5-5/8"
- 1MCD8P: 2" x 10-5/8"
- 1MCD2M: 1-7/16" x 2-11/16"
- 1MCD4M: 1-7/16" x 5-3/16"
- 1MCD8M: 1-7/16" x 10-3/16"

LISTINGS

Dry/Damp location. NRTL/CSA-US tested to UL standards. IBEW union made.



NOTES

- Not for use in corrosive environment
- Use of pressure washer voids warranty
- Ambient temperatures at fixture location should not exceed 40°C during normal operation.

PHOTOMETRICS

Consult factory or website for IES files. Tested in accordance with IESNA LM79.

2-Cell Recess Multicell Remote Power Supply Requirements and Wiring Diagrams

2-Cell can be wired in homeruns (wiring diagram A) or in series pairs (wiring diagram B).

If you want to connect **1-2 fixtures maximum** per power supply select from the following options:

Remote Power Supply Dimming Option	Dimming Driver Type	Wire Gauge Required*	Minimum Enclosure Size Required (by others)
RV08A	EldoLED 0-10V, 1%	18/16	6.25" W x 4" L x 2" H

- * Wire gauge 14/12 = Maximum distance from light fixture to remote power supply is 100' using 12 gauge wire, 50' using 14 gauge wire.
- * Wire gauge 18/16 = Maximum distance from light fixture to remote power supply is 100' using 16 gauge wire, 50' using 18 gauge wire.

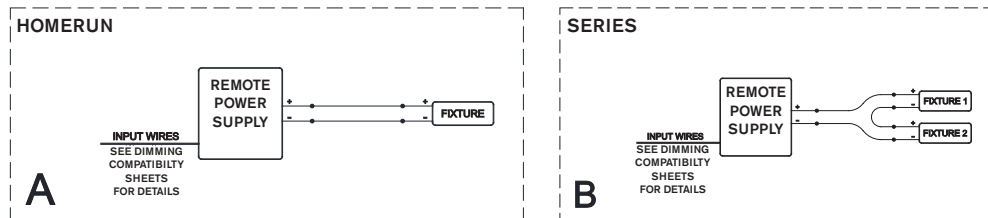

Requirements and Wiring Diagrams for 1MCD2

Recess Multicell Classic White Downlight

4 and 8-Cell Recess Multicell Remote Power Supply Requirements and Wiring Diagrams Must be wired in homeruns per wiring diagram "A" below.

If you want to connect **1 fixture maximum** per power supply select from the following options:

Remote Power Supply Dimming Option	Dimming Driver Type	Wire Gauge Required*	Minimum Enclosure Size Required (by others)
RV13A	EldoLED 0-10V, 1%	18/16	6.25" W X 4" L X 2" H
RV27A	EldoLED 0-10V, 1%	18/16	6.25" W X 4" L X 2" H
RP13A	Hatch 2-wire phase, 1%	14/12	5.75" W X 2.625" L X 2" H
RP27A	Hatch 2-wire phase, 1%	14/12	5.75" W X 2.625" L X 2" H

Requirements and Wiring Diagrams for M1CD4, M1CD8

* Wire gauge 14/12 = Maximum distance from light fixture to remote power supply is 100' using 12 gauge wire, 50' using 14 gauge wire.
 * Wire gauge 18/16 = Maximum distance from light fixture to remote power supply is 100' using 16 gauge wire, 50' using 18 gauge wire.

